

Step-by-Step Instructions

(PRINT this set of instructions to follow every time you refill your cartridge)

Brother LC51 Black/Cyan/Magenta/Yellow

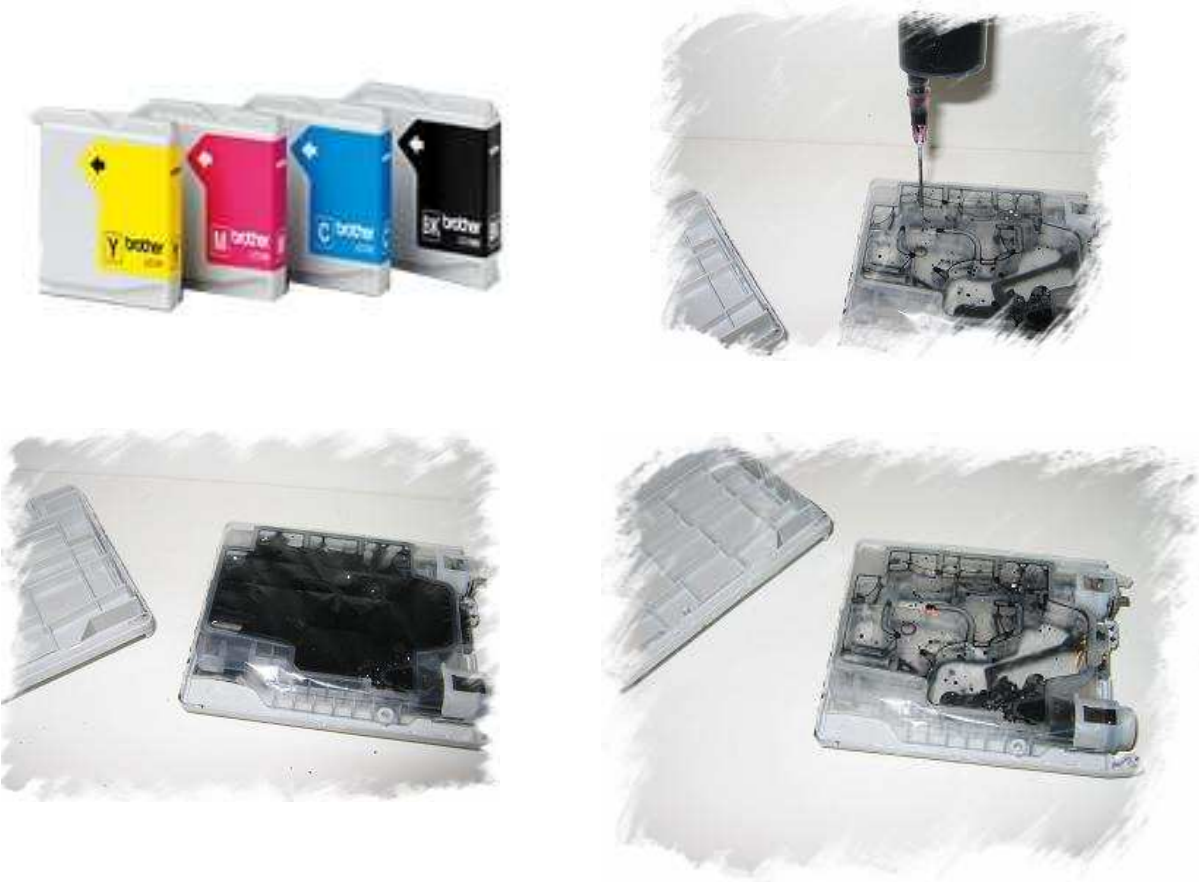

Items needed: gloves, hand-drill, small hand wrench, #2 refill station, Aluminum flat tape plug, Black Dye, Cyan, Magenta, Yellow inks, paper towels, review hints & tips and check list Note: Plug fill-hole with aluminum flat tape.

Syringe: Attach needle tip (located inside station # 4) to the syringe tightly. Unscrew lid on ink bottle. Puncture silver seal with needle tip making a small hole in the center of seal. Using the correct color pull the correct amount of ink into the syringe. Rinse syringe and needle tip after every use and before using syringe with another color. Rinse syringe and needle tip with water until the water runs clear.

1. Cut label at joint between top and bottom halves of the cartridge case.

2. Pull apart the cartridge casing shell by wedging a small screw driver or the small hand wrench (included in your parts pack inside station # 4) inside the back top of the canal on the top of your cartridge. Wiggle the screwdriver or wrench to pop open the casing shell.

3. Pierce the top part of the cartridge with the needle as shown in picture. S-l-o-w-l-y release thru the syringe 15 ml of black ink into cartridge bag. Holding the bottle upside down it is 5 mls from the top to the first marker line and then 3 mls each marker line. Use Black dye for Black; Follow the same instructions for Cyan, Magenta and Yellow. Use Cyan for Blue, Magenta for Red, and Yellow for yellow

The black cartridge will take up to 15mls

The color cartridges will take up to 15 mls

4. Put a piece of aluminum tape over the filling hole.

5. Place the casing shell back together and use a piece of aluminum flat tape to hold the two sides of the casing (shell) together. **Do not bump or press the "pressure release button".**

6. Replace the cartridge(s) and run 1 - 3 cleaning cycles as per printer instructions. [Or Print 3 pages using:](#)

http://www.refills4you.com/support/black_print_test.html Black ink test

http://www.refills4you.com/support/color_print_test.html Color ink Test

Alternate instructions



Items needed: gloves, hand-drill, #2 refill station, Aluminum flat tape plug, Black Dye, Cyan, Magenta, Yellow inks, paper towels, review hints & tips and check list
Note: Plug fill-hole with aluminum flat tape.

Syringe: Attach needle tip (located inside station # 4) to the syringe tightly. Unscrew lid on ink bottle. Puncture silver seal with needle tip making a small hole in the center of seal. Using the correct color pull the correct amount of ink into the syringe. Rinse syringe and needle tip after every use and before using syringe with another color. Rinse syringe and needle tip with water until the water runs clear.

1. Cut label at joint between top and bottom halves of the cartridge case.
2. Pull inner cartridge out of the casing shell.
3. Remove the cartridge from the casing (shell).
4. There is a round hole (well) in the top of the cartridge. Inside the hole or well is a rubber stopper. Use the hand drill and drill through the rubber stopper. **Do not bump or press the "pressure release button".**
5. Insert the blunt needle through the drilled stopper hole and into the cartridge body. **Be sure the needle (even though it is blunt) does not press up against the bag and punctures it.**
6. S-l-o-w-l-y release thru the syringe 15 ml of black ink into cartridge bag. Holding the bottle upside down it is 5 mls from the top to the first marker line and then 3 mls each marker line. Use Black dye for Black; Follow the same instructions for Cyan, Magenta and Yellow. Use Cyan for Blue, Magenta for Red, and Yellow for yellow
7. Seal the hole using a small set screw.
8. Place the cartridge back into its casing (shell) and use a piece of tape to hold the two sides of the casing shell together.
9. Replace the cartridge(s) and run 1 - 3 cleaning cycles as per printer instructions.
[Or Print 3 pages using:](#)

http://www.refills4you.com/support/black_print_test.html Black ink test
http://www.refills4you.com/support/color_print_test.html Color ink Test

AccuBrite, Inc. is not affiliated with the listed printer manufacturers or their subsidiaries. The use by AccuBrite, Inc. does not imply endorsement by or association with the brand name owners. The listed manufacturers, printers and cartridges are used only for the purpose of showing the compatibility of this AccuBrite, Inc. product. All other trademarks, brand names and logos referenced in or on this product are the property of their respective owners. This material is protected by the copyright laws of the United States and other countries. It is illegal to reproduce these instructions. It may not be reproduced, distributed, or altered in any fashion by any entity (either internal or external to AccuBrite), except in accordance with applicable agreements or contracts of licensing, without the express written consent of AccuBrite, Inc.

Copyright © AccuBrite, Inc. 2003-2008. All rights reserved